



Railway Signaling

	Type RS6932 40V 20/20W BA20d
	Ordering – No. 46932
Product Description	Signaling Lamp
Features	Double Filament
Applications	Railway Signal

Technical Details

Type	RS6932
Rated Voltage (V)	40
Wattage (W) (MF/AF) (at 40V)	max. 21,4 / 21,4
Luminous Flux (lm) (MF/AF) (at 40V)	225 / 225 -10%
Lumen Maintenance (MF/AF) (at 40V)	75% at 450 h
Life (h) (MF/AF) (at 40V)	600 / 50
Base	BA20d
Maximum Overall Length (mm)	67,0 -5,0
Bulb Diameter (mm)	35,0 ± 1,0
Light Center (mm) (MF)	30,0 ± 0,25
Filament Distance (mm) (MF-AF)	2,2 ± 0,8
Packaging Configuration	200 pcs.
Environmental Remark	Product don't contain lead or mercury and is conform with Directive 2011/65/EC "Restriction of the use of certain hazardous substances in electrical and electronic equipment".

Drawing (in mm)

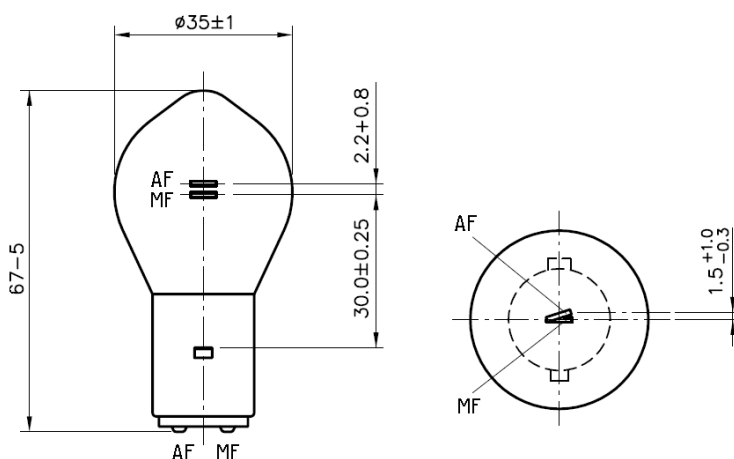

valid from	04.03.2014—V2—PN14/0072
replace for	28.01.2013—V1
file	46932.100.pdf