



Airfield Halogen Bipin



Type 6315
6,6A 36W G6,35

Ordering – No.
58315

Product description

Halogen Airfield Lamp with Bi-pin base

Features

high and constant lumen output, long lifetime, small size

Applications

Approach lights
Threshold lights
Runway lights
Taxiway lights
Obstruction lights

Technical Details

Rated current (A)	6,6
Wattage (W)	36 +/- 10%
Luminous flux (lm)	610 +/- 10%
Lumen maintenance	min. 90% after 562 h
Average lifetime (hours)	1500
Base	G6,35-15
Maximum Overall Length (mm)	max. 47
Bulb Diameter (mm)	max. 11
Light Center Length (mm)	33,0 +/- 0,5
Maximum allowed pinch temperature (°C)	350
Filament Type	C-8
Burning Position	S
Chromaticity	Within white boundaries
Packaging quantity	100 pcs.
Environmental remark	Product don't contain lead or mercury and is conform with Directive 2011/65/EC "Restriction of the use of certain hazardous substances in electrical and electronic equipment".

Drawing (in mm)

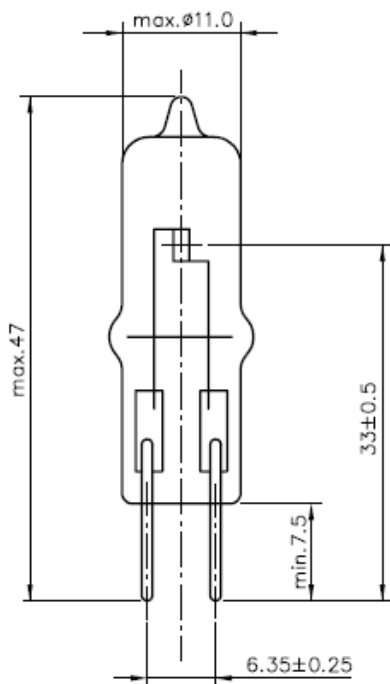

valid from	24.03.2014—V3—PN14/0162
replace for	05.03.2014—V2
file	58315.100.pdf